

127

Route Guide & Hazard Awareness

**TOOTING BROADWAY - SOUTHCROFT ROAD - MITCHAM
CARSHALTON - WALLINGTON - WOODCOTE - PURLEY**



CONTENTS

FULL ROUTE 127 MAP

Between Tooting
Broadway and
Mitcham.

3

FULL ROUTE 127 MAP

Between
Mitcham and
Carshalton.

4

FULL ROUTE 127 MAP

Between
Carshalton and
Woodcote.

5

FULL ROUTE 127 MAP

Between
Woodcote and
Purley.

6

RUNNING LIGHT

To and from
Tooting
Broadway.

7

RUNNING LIGHT

To and from
Purley station.

8

IN SERVICE

Route guide
from Tooting
Broadway to
Purley station.

9

IN SERVICE

Route guide
from Purley
station to Tooting
Broadway.

10

TOOTING BROADWAY

Terminus point
and map.

11

MITCHAM GLEBE COURT

Curtailment
point and map.

12

HACKBRIDGE ELM ROAD

Curtailment point
and map.

13

CARSHALTON WRYTHE GRN

Curtailment point
and map.

14

WALLINGTON STATION

Curtailment point
and map. Turning
point only.

15

WALLINGTON SHOTFIELD

Curtailment point
and map.

16

WOODCOTE FARM LANE

Curtailment point
and map. Turning
point only.

17

PURLEY STATION

Terminus point
and map.

18

LOCAL HAZARDS

Hazards to be
aware of and
other points to
note.

19

LOCAL HAZARDS

Hazards to be
aware of and
other points to
note.

20

LOCAL HAZARDS

Hazards to be
aware of and
other points to
note.

21

LOCAL HAZARDS

Hazards to be
aware of and
other points to
note.

22

AT THE GARAGE

General
information and
safety at the
garage.

23

CODES & PROCEDURES

Facility codes,
curtailment abrv
& emergency radio
procedure.

24

COMMONSIDE WEST

Curtailment point
and map.

25

LONGMEAD ROAD

Standing
arrangement
at Tooting
Broadway.

26

ROUTE 127 MAP

TOOTING BROADWAY AND MITCHAM

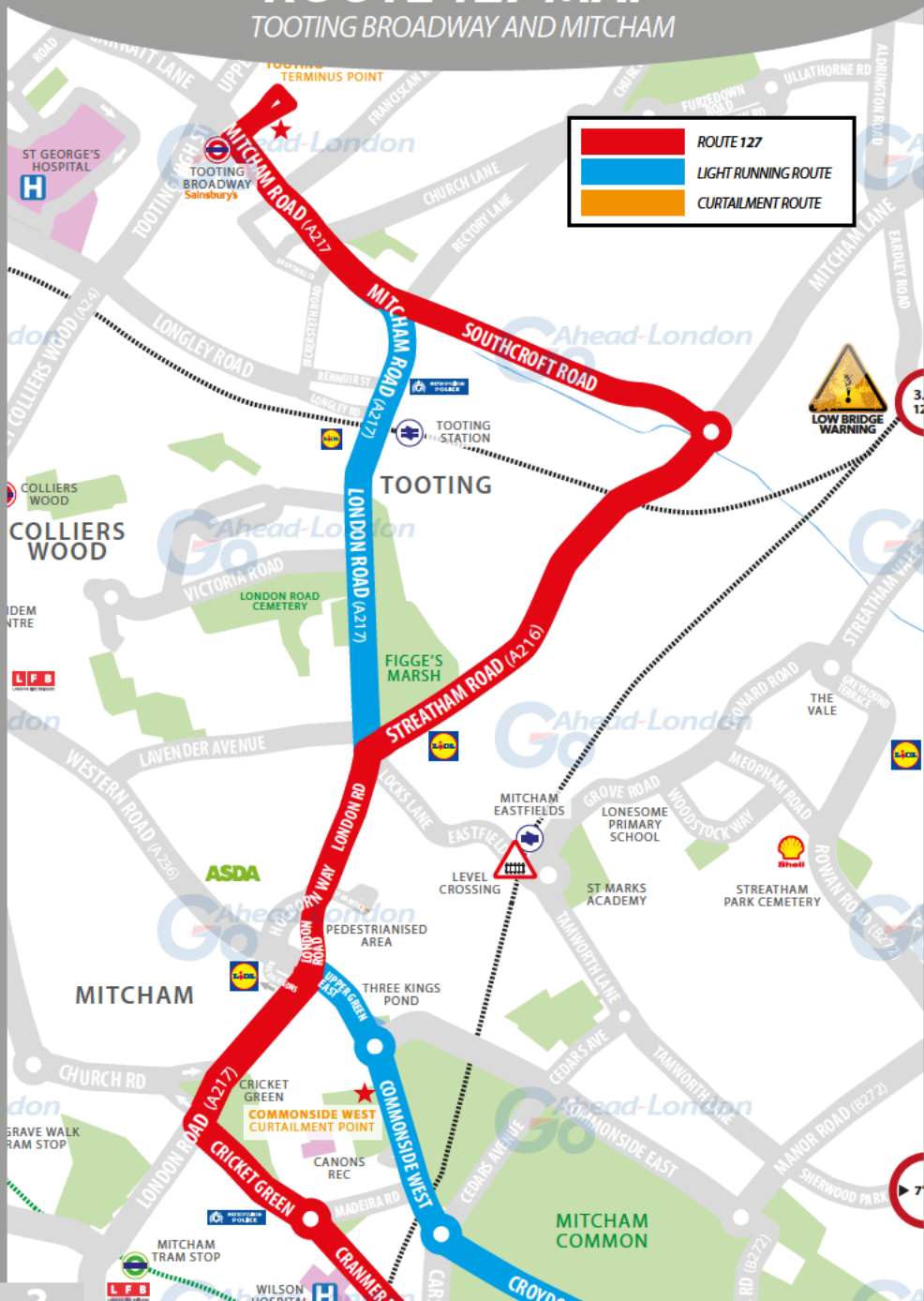

ROUTE 127 MAP

MITCHAM AND CARSHALTON

THIS GUIDE IS
DESIGNED TO
ASSIST YOU ON
ROUTE 127.
ENJOY!



ROUTE 127 MAP

CARSHALTON AND WOODCOTE



GO TO PAGE 4

GO TO PAGE 6

ROUTE 127 MAP

WOODCOTE AND PURLEY

REMEMBER
MOBILE PHONES
ARE NOT ALLOWED
IN THE CAB AT
ANY TIME

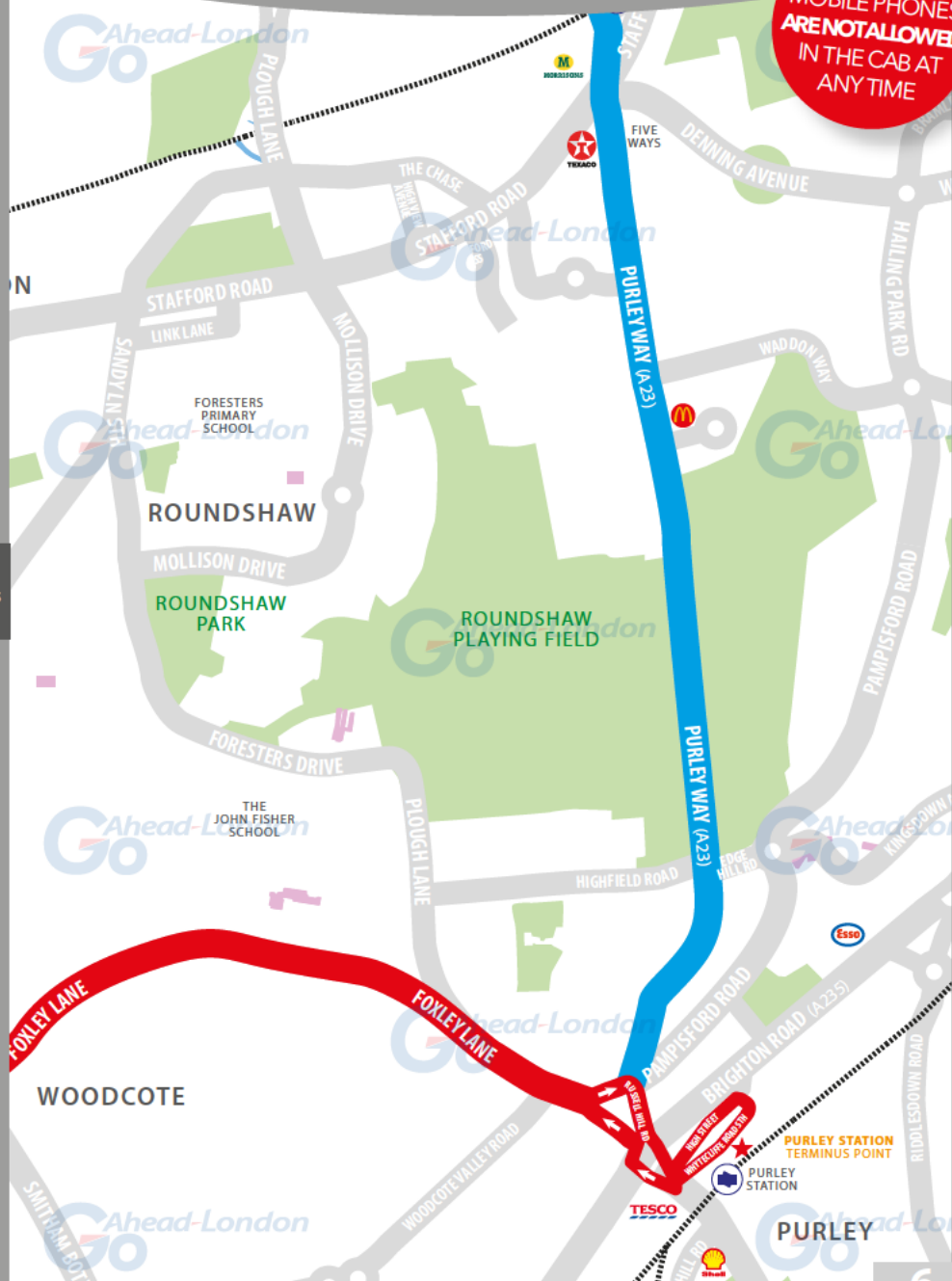

GO TO
PAGE 5

RUNNING LIGHT

RUNNING OUT OF SERVICE

IMPORTANT
LOG OFF IBUS
IMMEDIATELY
IF RUNNING
LIGHT

TO TOOTING BROADWAY

- From **Croydon Garage**, turn right onto Beddington Lane **B272**
- At roundabout, continue ahead on Beddington Lane **B272**
- At traffic light, turn left onto Croydon Road **A236**
- At roundabout, take 2nd exit onto Commonside West **A236**
- At roundabout, take 1st exit onto Commonside West and Upper Green East **A236**
- At traffic light, turn right onto London Road (*buses only*)
- At traffic light, continue ahead onto London Road **A217**
- At roundabout, take 2nd exit onto London Road **A217**
- Continue ahead onto Mitcham Road (*past Tooting station*) **A217**
- At traffic light, follow the road left onto Mitcham Road **A217**
- Turn right onto Longmead Road to **stand** (*McDonalds on the left before turn*)

FROM TOOTING BROADWAY

- From **stand**, turn left onto Mitcham Road **A217**
- At traffic light, follow the road right onto Mitcham Road **A217**
- Continue ahead onto London Road (*past Tooting station*) **A217**
- At roundabout, take 3rd exit onto London Road **A217**
- At traffic light, continue ahead onto London Road (*buses only*)
- At traffic light, turn left onto Upper Green East **A236**
- Continue ahead onto Commonside West **A236**
- At Three Kings Pond roundabout, take 2nd exit onto Commonside West **A236**
- At roundabout, take 1st exit onto Croydon Road **A236**
- At traffic light, turn right onto Beddington Lane **B272**
- At roundabout, continue ahead on Beddington Lane **B272**
- Turn left into **Croydon Garage**



SHORTS ROAD
CLEARANCE HEIGHT

DOUBLE DECK VEHICLES MUST
NOT BE USED ON THIS ROAD

Off line-of route, west of West Street in Carshalton

RUNNING LIGHT

RUNNING OUT OF SERVICE

IMPORTANT
LOG OFF IBUS
IMMEDIATELY
IF RUNNING
LIGHT

TO PURLEY STATION

- From **Croydon Garage**, turn right onto Beddington Lane **B272**
- At roundabout, take 2nd exit onto Coomber Way
- At roundabout, take 1st exit onto Ampere Way
- At elongated roundabout take 1st exit onto Ampere Way
- Continue under overpass on Ampere Way
- Continue ahead onto Purley Way to Purley (*past Five Ways*) **A23**
- At traffic light, follow the ahead onto Russell Hill Road/one-way system **A23**
- At traffic light, follow the ahead onto Brighton Road **A23**
- Continue ahead onto Purley Road **A22**
- At traffic light, turn left onto High Street (*before railway bridge*)
- At traffic light, turn right onto Whytecliffe Road South to **stand**

FROM PURLEY STATION

- From **stand**, continue ahead on Whytecliffe Road South
- At traffic light, turn right onto Purley Road/one-way system **A22**
- At traffic light, turn right onto Brighton Road/one-way system **A23**
- At traffic light, turn left onto Banstead Road/one-way system **A23**
- Keep right and turn right onto Foxley Lane/one-way system **A23**
- At traffic light, turn left onto Purley Way **A23**
- Continue ahead onto Purley Way (*past Five Ways*) **A23**
- Take slip road onto Ampere Way towards IKEA
- At elongated roundabout take 2nd exit onto Ampere Way
- At roundabout, take 2nd exit onto Coomber Way
- At roundabout, take 1st exit onto Beddington Lane **B272**



EARDLEY ROAD
CLEARANCE HEIGHT

**DOUBLE DECK VEHICLES MUST
NOT BE USED ON THIS ROAD**

Off line-of route, north east of Mitcham Lane

ROUTE DIRECTIONS

RUNNING IN SERVICE

NEVER
DIVERT OFF
LINE OF ROUTE
UNLESS ADVISED
BY IBUS

TO PURLEY STATION

- From **stand**, turn left onto Mitcham Road **A217**
- At traffic light, stay on left lane and continue onto Amen Corner
- Continue ahead onto Southcroft Road
- At roundabout, take 2nd exit onto Streatham Road **A216**
- At roundabout, take 2nd exit onto London Road **A217**
- At traffic light, continue ahead onto London Road (*buses only*)
- At traffic light, continue ahead onto London Road **A217**
- At traffic light, turn left onto Cricket Green **A239**
- At roundabout, take 2nd exit onto Cranmer Road **A239**
- At junction, turn right onto Carshalton Road (*past Mitcham Junction station*) **A237**
- At roundabout, take 1st exit onto London Road **A239**
- At roundabout, take 2nd exit onto Hackbridge Road **B277**
- At roundabout, take 1st exit onto North Street (*past Carshalton College*)
- At junction, turn left onto Pound Street (next to Carshalton Pond) **A232**
- Continue ahead onto High Street and Acre Lane **A232**
- Turn right onto Park Lane (after ATS tyre shop on right)
- Turn left onto Parkgate Road
- At junction, turn right onto Manor Road (*past Wallington station*) **A237**
- Continue ahead onto Woodcote Road (*past Sainsbury's on the left*) **A237**
- At roundabout, take 2nd exit onto Woodcote Road **A237**
- At roundabout, take 1st exit onto Foxley Lane **A2022**
- At one-way system, keep on right lane and continue onto Foxley Lane **A23**
- At traffic light, turn right onto Russell Hill Road **A23**
- At traffic light, follow the ahead onto Brighton Road **A23**
- Continue ahead onto Purley Road **A22**
- At traffic light, turn left onto High Street (*before railway bridge*)
- At traffic light, turn right onto Whytecliffe Road South to **stand**

ROUTE DIRECTIONS

RUNNING IN SERVICE

IMPORTANT
PLEASE ENSURE
YOU USE YOUR
RIBAS KEY ON
EVERY TRIP

TO TOOTING BROADWAY

- From **stand**, continue ahead on Whytecliffe Road South
- At traffic light, keep left on continue straight head towards the left **A22**
- At junction, turn right onto Purley Road **A22**
- Keep left and use Tesco slip road to serve stop P
- Exit slip road and continue on Purley Road/one-way system
- At traffic light, turn right onto Brighton Road/one-way system **A23**
- At traffic light, turn left onto Banstead Road/one-way system **A23**
- Keep left and continue onto Foxley Lane **A2022**
- At roundabout, take 3rd exit onto Woodcote Road **A237**
- At roundabout, take 2nd exit onto Woodcote Road **A237**
- Continue ahead onto Woodcote Road (*past Sainsbury's on the right*) **A237**
- Turn left onto Railway Approach to serve Wallington station
- Circumnavigate Railway Approach and exit
- Turn left onto Manor Road **A237**
- Turn left onto Parkgate Road
- At junction, turn right onto Park Lane
- At junction, turn left onto Acre Lane and High Street **A232**
- Continue ahead onto Pound Street **A232**
- Turn right onto North Street (*next to Carshalton Pond*)
- At roundabout, take 2nd exit onto Hackbridge Road **B277**
- At roundabout, take 1st exit onto London Road **A237**
- At roundabout, take 2nd exit onto London Road **A237**
- Continue ahead onto Carshalton Road (*past Mitcham Junction station*) **A237**
- Turn left onto Cranmer Road **A239**
- At roundabout, take 1st exit onto Cricket Green **A239**
- At traffic light, turn right onto London Road **A217**
- Follow the road to the left onto Lower Green West **A217**
- Keep right and follow the road right onto Lower Green West **A217**
- Keep left and follow the road left onto London Road **A217**
- Use filter lane and continue ahead onto London Road **A217**
- At traffic light, continue ahead onto London Road (*buses only*)
- At traffic light, continue ahead onto London Road **A217**
- At roundabout, take 3rd exit onto Streatham Road (*past railway bridge*) **A216**
- At roundabout, take 1st exit onto Southcroft Road **A239**
- At traffic light, follow the road onto Amen Corner and Mitcham Road **A217**
- Turn right onto Longmead Road to **stand** (*McDonalds on the left before turn*)

TOOTING BROADWAY

TERMINUS POINT

SWITCH THE
ENGINE OFF
WHILST AT THE
STAND

From Purley. Proceed from Mitcham Road to stand on Longmead Road. Set down on Mitcham Road at **BUS STOP R**.

Towards Purley. Depart via Longmead Road turning circle. Pick up on Mitcham Road at **BUS STOP C**.

Public stand for two buses on north side of Longmead Road. No more than 1 bus on Route 127 should be scheduled to stand at any one time.

Blind display: **TOOTING BROADWAY**.

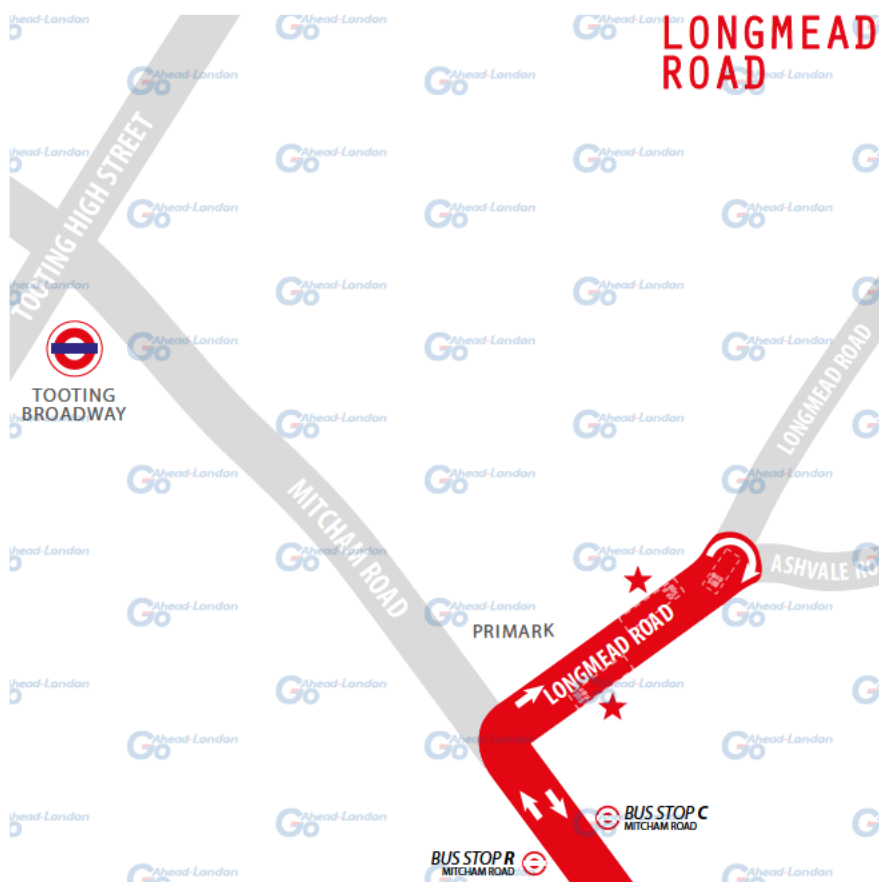

MITCHAM

CURTALMENT POINT

IMPORTANT
PLEASE ENSURE
YOU USE YOUR
RIBAS KEY ON
EVERY TRIP

From Purley. Proceed from London Road via Raleigh Gardens, Upper Green West, Upper Green East, Commonside West, Turning Circle and Commonside West to stand. Set down in London Road at **BUS STOP Q**.

Towards Purley. Depart via Commonside West and Upper Green East to London Road. Pick up in London Road at **BUS STOP M**.

Public stand for four buses in 2 portions on the west side of Commonside West. See page 23 for stand arrangement. **Blind display: MITCHAM.**



HACKBRIDGE

CURTAILMENT POINT

PLEASE CHECK
TRIP NUMBER
ON ETM BEFORE
DEPARTING

From Purley. Proceed from Hackbridge Road via London Road, Longfield Avenue and Elm Road to stand.
Set down on Hackbridge Road at **BUS STOP A**.

Towards Purley. Depart via Elm Road to Hackbridge Road.
Pick up on Hackbridge Road at **BUS STOP H**.

From Tooting Broadway. Proceed from London Road via Longfield Avenue and Elm Road to stand. Set down on London Road at **BUS STOP T**.

Towards Tooting Broadway. Depart via Elm Road and Hackbridge Road to London Road. Pick up on London Road at **BUS STOP P**.

Public stand for three buses on east side of Elm Road.

Blind display: **HACKBRIDGE CORNER**.



CARSHALTON

CURTAILMENT POINT

PLEASE CHECK
TRIP NUMBER
ON ETM BEFORE
DEPARTING

From Purley. Proceed from North Street via Wrythe Green Road and West Street to stand. Set down on North Street at **BUS STOP A.**

Towards Purley. Depart via West Street, Wrythe Lane and Wrythe Green Road to North Street. Pick up on North Street at **BUS STOP C.**

From Tooting Broadway. Proceed from Nightingale Road via Wrythe Green Road and West Street to stand. Set down on Nightingale Road at **BUS STOP K.**

Towards Tooting Broadway. Depart via West Street, Wrythe Lane and Wrythe Green Road to Nightingale Road. Pick up on Nightingale Road at **BUS STOP J.**

Public offside stand for one bus on west side of West Street.

Blind display: **WRYTHE GREEN.**

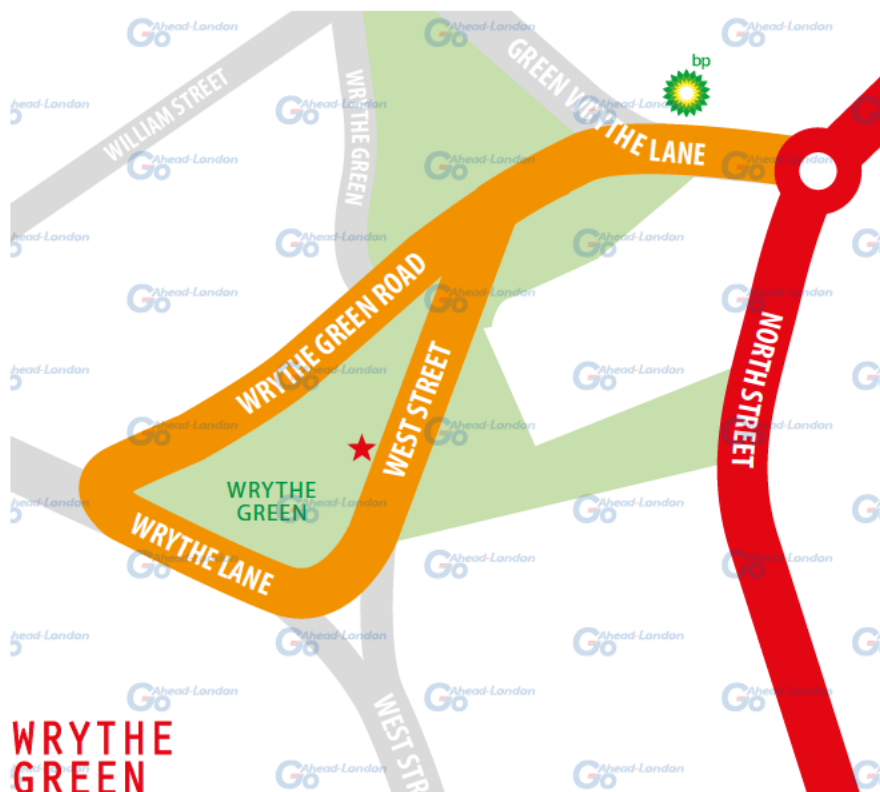

WALLINGTON STATION

TURNING POINT

TURNING POINT ONLY.
BUSES MUST NOT STAND.

From Purley. Proceed from Railway Approach Turning Circle via Railway Approach and Manor Road.

Set down on Station Approach at **BUS STOP C.**

Towards Purley. Depart via Railway Approach.

Pick up on Railway Approach at **BUS STOP J.**

Turning point only - buses must not stand.

Blind display: **WALLINGTON.**

**RAILWAY
APPROACH**

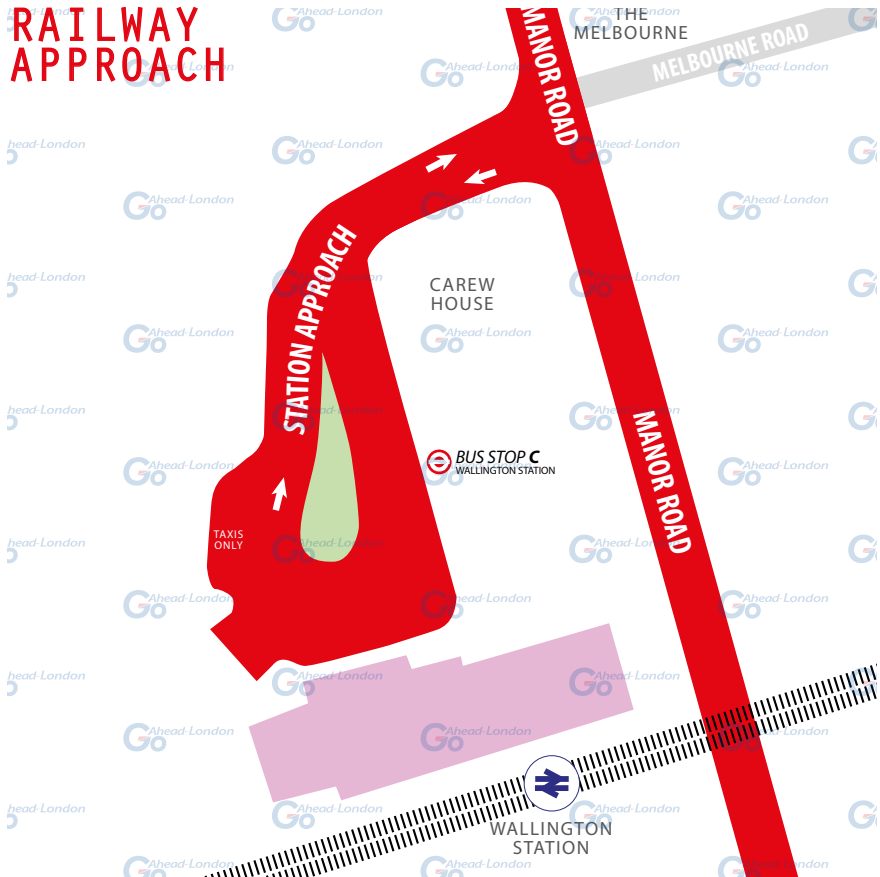

WALLINGTON

CURTALMENT POINT

IMPORTANT
IF YOU REQUIRE A
COMFORT BREAK,
PLEASE ADVISE
IBUS

From Tooting Broadway. Proceed from Manor Road via Beddington Gardens and Shotfield to stand. Set down on Manor Road at **BUS STOP A.**

Towards Tooting Broadway. Depart via Shotfield and Stanley Park Road to Woodcote Road. Pick up on Woodcote Road at **BUS STOP K.**

Public stand for two buses on east side of Shotfield.

Blind display: **WALLINGTON.**

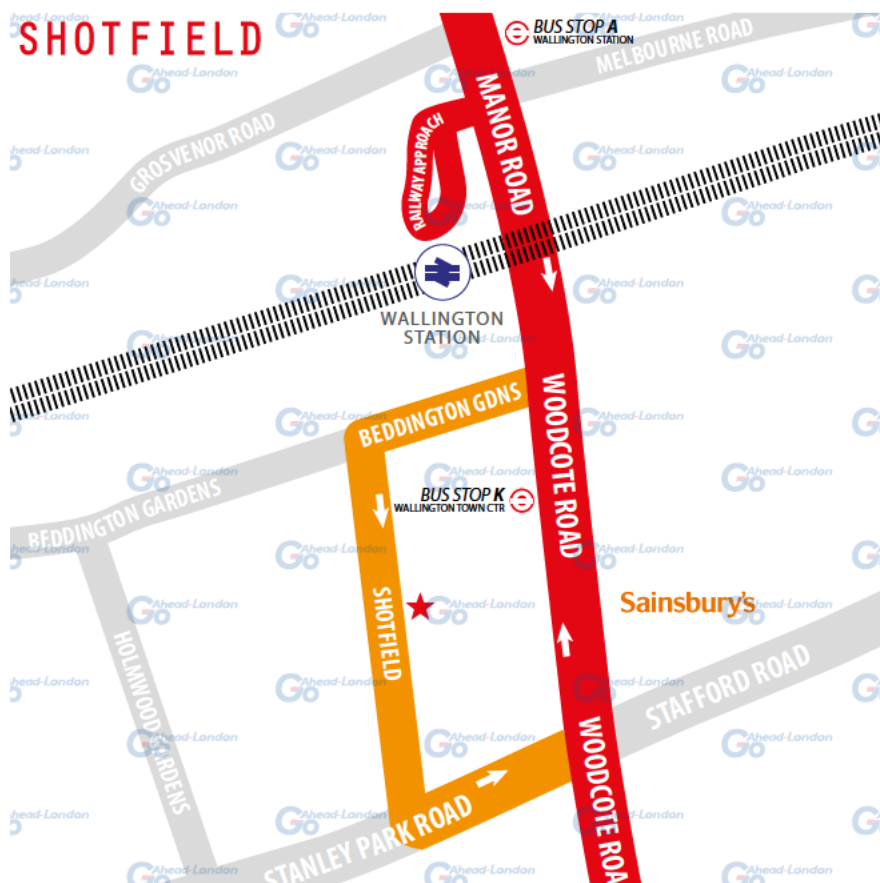

WOODCOTE

TURNING POINT

TURNING POINT ONLY.
BUSES MUST NOT STAND.

From Tooting Broadway. Proceed from Woodcote Road via Smitham Bottom Lane, Woodcote Park Avenue and Smitham Bottom Lane. Set down on Woodcote Road at **BUS STOP T**.

Towards Tooting Broadway. Circumnavigate the small green off Smitham Bottom Lane. Depart to Woodcote Rd. Pick up on Woodcote Road at **BUS STOP V**.

Turning point only - buses must not stand.

Blind display: **WOODCOTE GREEN.**



LOCAL HAZARDS & POINTS TO NOTE

SEE RISK ASSESSMENT VIEWABLE UPON REQUEST



SMALL BUS STAND SPACE | LONGMEAD ROAD

Very small bus stand with multiple routes terminating. Pedestrians walking in front and behind buses. Traffic passing through stand. Tight manoeuvres necessary. Risk of collision with mirrors. Max speed 5mph. Be aware of moving traffic and pedestrians. very slow when manoeuvring. good mirror work needed. Hi Vis to be worn on stand when alighting bus.

TIGHT TURN | MITCHAM ROAD

Bus stop immediately after left turn from Longmead Road stand, tight turn. Turning from Longmead Road be aware of traffic on opposite side of the road.

SPEED TABLES | MITCHAM ROAD

Funeral cars in bus lane by Catholic Church. Use appropriate speed over raised tables to avoid damage to bus, be aware of parked funeral cars.

SPEED TABLES | SOUTHCROFT ROAD

Use appropriate speed over raised tables and cushions to avoid damage to bus.

PARKED VEHICLES | SOUTHCROFT ROAD

Vehicles parked immediately before bus stop junction with Mitcham Road. Care required entering stop to avoid front overhang colliding with waiting passengers and risk of collision with parked vehicles. Risk of mirrors hitting flag.

RISK OF COLLISION | LONDON ROAD

Both ways. New road layout, buses and cyclist only, pedestrianised road. Risk of collision due to customers exiting either side of pubs especially at weekends. Extreme care and caution when proceeding, looking at for any pedestrians trying to cross under the influence of alcohol. Risk of pedestrian/cyclist collision. Extreme care and caution when proceeding, looking at for any pedestrians/cyclist. Do not exceed the 20 mph speed limit.

ROAD LAYOUT CHANGE | LONDON ROAD

Towards Tooting Broadway. New road layout, buses and cyclists only. Risk of pedestrian/cyclist collision. Proceed with extreme care and caution when proceeding through the contraflow bus lane looking out for pedestrians and cyclists crossing.

LOCAL HAZARDS & POINTS TO NOTE

SEE RISK ASSESSMENT VIEWABLE UPON REQUEST



VARIOUS HAZARDS | LONDON ROAD

Parked cars. Ensure there is enough road space to proceed and look out for oncoming vehicles. Roundabout removed, narrow lanes and high kerb. Proceed with care and caution.

NO FOOTPATH | CRANMER ROAD

No footpath on common side, narrow bridge, bell. Be aware of pedestrians crossing from common, watch out for oncoming large vehicles.

LIMITED VISIBILITY | CRANMER RD/CARSHALTON RD

Limited visibility to left. Care needed for approaching traffic from left due to angle of junction.

NEW ROAD LAYOUT | LONDON ROAD/HACKBRIDGE ROAD

Courtesy crossings, mini roundabout. New style courtesy crossings give way to pedestrians. Give way to traffic from right.

NARROW ROAD | HACKBRIDGE ROAD

Parked cars, congested pavements at school in/out times. Ensure that there is enough road space to proceed and look out for oncoming vehicles. Watch out for pedestrians in the road.

VARIOUS HAZARDS | NIGHTINGALE ROAD

Parked vehicles on both sides of road. Parked vehicles close to traffic islands. Raised pedestrian crossing. Look out for oncoming vehicles and ensure there is enough road space to proceed. Drive over raised pedestrian crossing slowly and with care to avoid poor ride quality, injury to passengers/driver and damage to vehicle. Recommended max speed 10 mph.

ZEBRA CROSSING | NIGHTINGALE ROAD/NORTH STREET

New Zebra Crossing for Carshalton College. Proceed with care and caution, watch out for persons intending to cross.

PARKED VEHICLES | NORTH STREET

Parked vehicles on both sides of road and close to traffic islands. Speed cushions. Look out for oncoming vehicles and ensure there is enough road space to proceed. Use appropriate speed over cushions to avoid damage to bus.

LOCAL HAZARDS & POINTS TO NOTE

SEE RISK ASSESSMENT VIEWABLE UPON REQUEST



TIGHT TURN | NORTH STREET/HIGH STREET

Tight left turn into High Street. Ensure you have sufficient room to turn, oncoming traffic from right may need to give way.

NARROW ROAD | HIGH STREET CARSHALTON

Narrow road, especially by ponds. Need to use centre of road at bend by pond, wait for oncoming traffic to give way.

NARROW ROAD | HIGH STREET CARSHALTON

Narrow road and pavement. Look for oncoming traffic, watch out for pedestrians in the road/close to kerb.

TRAFFIC | HIGH STREET/PARKGATE ROAD

Fast approaching traffic. Care and caution needed when turning in and out of Parkgate Road.

PARKED VEHICLES | PARKGATE ROAD

Parked vehicles on both sides of road. Look out for oncoming vehicles and ensure there is enough road space to proceed.

RAILWAY BRIDGE FLOODING | MANOR ROAD

In heavy rain, dip to railway bridge floods.

PEDESTRIANS | MANOR ROAD/WALLINGTON ROAD

Pedestrians crossing junction. Care needed when turning into station.

PARKED VEHICLES | WOODCOTE ROAD

Narrow road. Look out for oncoming vehicles and ensure there is enough road space to proceed.

RAISED MINI ROUNDABOUT | WOODCOTE ROAD

Junction with Sandy Lane. Drive over raised mini roundabout slowly and with care to avoid poor ride quality, injury to passengers/driver and damage to vehicle. Recommended max speed 10 mph.

LOCAL HAZARDS & POINTS TO NOTE

SEE RISK ASSESSMENT VIEWABLE UPON REQUEST



BELL ON CORNER | WOODCOTE ROAD/FOXLEY LANE

Take care not to overhang pavement on turning left and colliding with bell.

NARROW ROAD | FOXLEY LANE

Parked vehicles on both sides of road. Look out for oncoming vehicles and ensure there is enough road space to proceed.

LANE DISCIPLINE | FOXLEY LANE/PURLEY CROSS

Banstead Road. Traffic light-controlled filter lanes. Ensure correct lane followed. Three lanes need to be crossed to serve bus stop at Purley Cross. Fast traffic coming from the A23 from the left. Blind spot from driver cab. Driver must look over shoulder to see oncoming traffic.

NARROW LANES | RUSSELL HILL ROAD

Be aware of other vehicles on either side.

PARKED VEHICLES | HIGH ST/WHYTECLIFFE ROAD SOUTH

Narrow Road, parked cars Be aware for car doors opening.

FILTER LANES | PURLEY ROAD

Traffic light-controlled filter lanes.

SCHOOL CHILDREN | SCHOOLS EN ROUTE

Eagle House School, Hackbridge Primary School, Carshalton College, Wallington High School for Girls, John Fisher School, Thomas Moore School. Be aware of large groups of pupils surging into the road space at bus stops.

AT THE GARAGE

GARAGE AND GENERAL SAFETY INFORMATION

BE VISIBLE
**WEAR YOUR
HI-VIS** WITHIN
THE GARAGE

GO SLOW!
MANDATORY
SPEED OF 5 MPH
WITHIN THE
GARAGE

BE NOTICED
HEADLIGHTS
ON AT ALL TIMES
IN THE GARAGE

STICK TO
DESIGNATED
PATHS AND
WALKWAYS

NO EXCUSES
PLEASE ABIDE BY
THE RULES. IT'S
MANDATORY!

BE AWARE.
REPORT ALL
HAZARDS
IMMEDIATELY

REMEMBER
**LOOK OUT
FOR CYCLISTS**
DRIVE SLOWLY

PARK FERRY
VEHICLES WITHIN
DESIGNATED
AREAS

**USE THE
HORN** WHEN
APPROACHING
CORNERS &
REVERSING

ELECTRIC
BUSES ARE
SILENT. BE **EXTRA
CAUTIOUS**

FUEL, OIL &
COOLANT SPILLS
CAN MAKE THE
SURFACE SLIPPERY
BE AWARE

FAMILIARISE
YOURSELF WITH
THE GARAGE
SAFETY CODE



AND THINK FIRST!

OTHER INFORMATION

CODES AND EMERGENCY RADIO PROCEDURES

REMAIN CALM:
GIVE ACCURATE
INFORMATION.
WE'RE HERE
TO ASSIST!

ROUTE 127 | CURTAILMENT ABBREVIATIONS

TBS	Tooting Broadway	MCW	Commonside West
HER	Hackbridge Elm Road	CWG	Carshalton Wrythe Green
WAL	Wallington station	WAS	Wallington Shotfield
WFL	Woodcote Farm Lane	PUR	Purley station

FACILITIES | THROUGHOUT THE ROUTE

- Tooting Broadway, North Side.
- Downe Road, Mitcham.
- Wallington station.
- Wallington Shotfield.
- Purley station.

If you urgently need to use a facility, please inform iBus immediately.

CODE RED | EMERGENCY RADIO PROCEDURE

If you require the Emergency Services to attend your vehicle (for example in the event of passenger injury, assault or major RTA), contact CentreComm using the radio's Code Red facility. To call CentreComm, **hold down the Code Red button on your vehicle's radio for at least 3 seconds** until you hear a ringing tone to indicate that your call has been connected. Hold down the foot switch in the cab when you are speaking, and end what you have to say with the word "over" to indicate that you expect a response. Release the foot switch when you are not speaking. Remember to speak slowly and clearly. You will usually receive a radio call from your depot shortly after you make a Code Red call. **You should not use the radio whilst the vehicle is in motion.**

CODE
GREEN

Call your garage for non-emergency, mechanical defects, help or advice

CODE
BLUE

Call CentreComm for non-emergency, incident reporting or diversions

CODE
RED

Call CentreComm for emergency services, passenger injury or assault

MITCHAM

STAND ARRANGEMENT

ONLY ONE
BUS ON ROUTE
127 ALLOWED
TO STAND

Public stand for four buses in 2 portions on the west side of Commonsides West. Only use this stand if advised by your iBus Controller. Toilet facilities are available here.

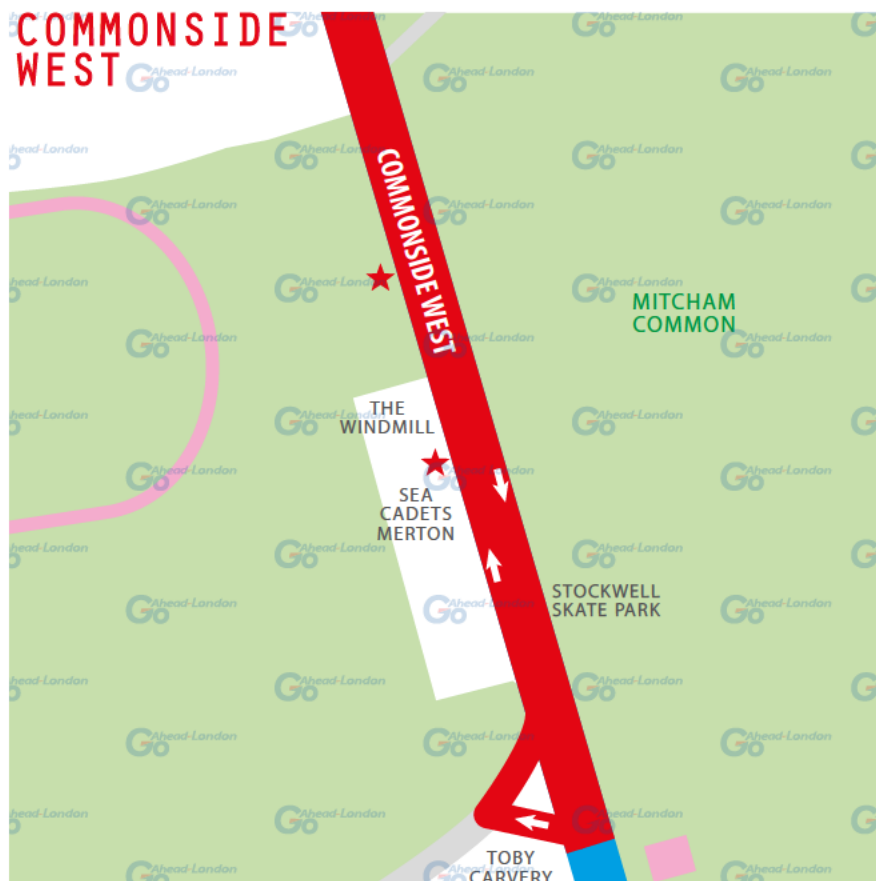

TOOTING BROADWAY

STAND ARRANGEMENT

ONLY ONE
BUS ON ROUTE
127 ALLOWED
TO STAND

Public stand for five buses in Longmead Road in three parts:

1. On north side of Longmead Road for three buses, commencing at a point 11 metres south of No 2 Longmead Road and extending 30 metres.
2. In the centre of Longmead Road for one bus.
3. On south side of Longmead Road for one bus, commencing at a point 14 metres east of eastern building line of Mitcham Road and extending 10 metres.

Please note: Due to the number of buses curtailing at this point, only one bus on route 127 allowed to stand at any one time. Do not arrive early.

